



BAMPTON AT THE TIME  
 OF THE ENCLOSURE ACT (1821)  
 1821.



Plan  
of the BUILDINGS in  
**BAMPTON**



Inrolled in His Majesty's Court of Common Pleas  
at Westminster of the Term of Easter in the Eighth  
Year of the Reign of King George the Fourth -  
Keane Fitzgerald













PLAN N<sup>o</sup> VI.  
A W A R D  
N<sup>o</sup> V  
T U R N P I K E R O A D  
D E E R O A D  
T H E B E A M R O A D  
A W

150  
The Dean & Chapter of Exeter  
and Edw<sup>d</sup> Whitaker Esq<sup>r</sup> their Lessee  
*2<sup>nd</sup> Allotment for Tithes*  
40 0 3

128  
The Rev<sup>d</sup> H. Owen  
*5<sup>th</sup> Allotment for Tithes*  
7 5 32

122  
The Dean & Chapter  
of Exeter  
E. Whitaker Lessee.  
*1<sup>st</sup> Allotment*  
38 1 28

127<sup>b</sup>  
The Rev<sup>d</sup> J. Francis  
*Allotment for  
Shepherds Copy<sup>d</sup>*  
16 1 54

127<sup>a</sup>  
John Kenn  
5 2 32

124  
The Dean & Chapter of Exeter  
E. Whitaker Lessee.  
*Allotment for Hawks Copy<sup>d</sup>*  
24 3 35

123  
5 1 54

126  
5 3 53

121  
The Dean & Chapter  
of Exeter.  
W. Smith Lessee.  
*2<sup>nd</sup> Allotment*  
19 1 38

125  
3 0 26

290  
Catherine Upjohn  
9 1 0

291  
Jos. Barratt Esq<sup>r</sup>  
7 3 18

114  
6 0 26

292  
3 1 31

120  
3 2 24

115

113

293  
1 0

112

117

Esq<sup>r</sup>

Esq<sup>r</sup>

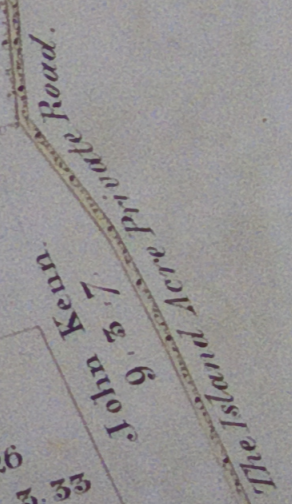
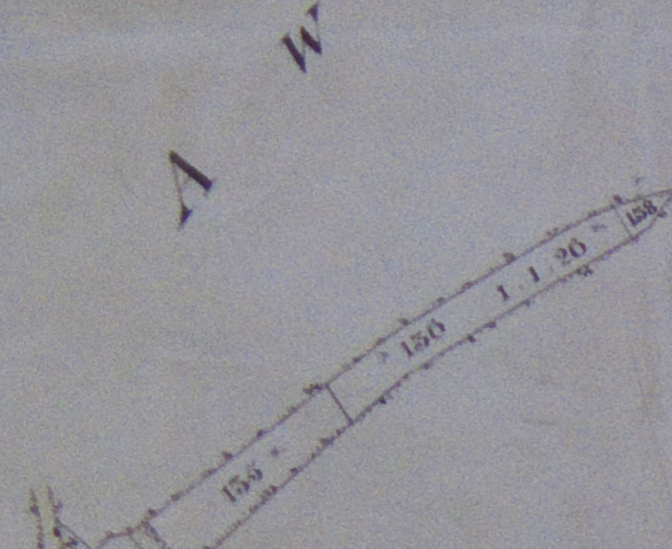



1st Allotment  
19 3 11

295.  
Jos<sup>s</sup> ANDREWS  
2<sup>nd</sup> Allotment  
30 0 3

Trulands Private Road

297  
298  
3 0 22  
200  
4 3 20  
300

301  
W. J. Walker  
7 0 29

503.  
Barnard Green  
12 0 31

THE  
ASTON ROAD

307  
4 2 29  
308  
309  
3 5 55

310  
3 1 15  
311  
1 1 25

312  
8 1 8

313  
4 2 17

314

380  
3 0 32  
379  
376  
377  
375  
2 0 19  
374  
372

371  
4 1 38  
370  
369

367

366

364.  
John Roberts.  
5<sup>th</sup> Allotment  
15 2 10

363.  
E. Whitaker Esq<sup>r</sup>  
6 2 5

362.  
Jos<sup>s</sup> Andrews.  
15 1 8

The Townsend Private Road

361  
4 2 18

360  
9 2 1

382a  
345  
344  
342  
343

346

347  
2 0 21

348  
3 0 16

349

350  
4 2 2

6 2 0

359

360

360

360

304  
2 0 10  
305  
4 0 8

306  
4 0 11

L

W

E

H

N

N<sup>o</sup> N.

SCALE of CH...





150  
The Dean & Chapter of Exeter  
Edw<sup>d</sup> Whitaker Esq<sup>r</sup> their Lessee  
2<sup>nd</sup> Allotment for Tithes  
40 0 3

128  
The Rev<sup>d</sup> H. Owen  
5<sup>th</sup> Allotment for Tithes  
7 5 32

122  
The Dean & Chapter of Exeter  
E. Whitaker Lessee  
1<sup>st</sup> Allotment  
38 1 28

127<sup>b</sup>  
The Rev<sup>d</sup> J. Francis  
Allotment for  
Shepherds Copy  
16 1 34

127<sup>a</sup>  
John Kenn  
5 2 32

124  
The Dean & Chapter of Exeter  
E. Whitaker Lessee  
1<sup>st</sup> Allotment for Hanks Copy  
24 3 35

127  
John Kenn  
9 3 7

126  
5 3 33

125  
3 0 26

290  
Catherine Upjohn  
9 1 0

291  
Jos. Barratt Esq<sup>r</sup>  
7 5 18

292  
3 1 31

293  
8 1 0

285  
THE REV<sup>d</sup> T. BURROW.  
4<sup>th</sup> Allotment for Tithes.  
11 7 0 32

286  
JOHN ROBERTS  
5<sup>th</sup> Allotment  
51 2 17

117  
E. Whitaker Esq<sup>r</sup>  
5<sup>th</sup> Allotment  
27 1 30

109  
E. Whitaker Esq<sup>r</sup>  
17 3 26

287  
SWINBROOK CHARITY  
29 2 7

294  
Shrewsbury

289  
Jos. Andrews

Wright  
5 2 17



THE REV. T. BURROW.

4<sup>th</sup> Allotment for Tithes.

117 0 32



121  
The Dean & Chapter  
of Exeter  
W. Smith Lessee  
2<sup>nd</sup> Allotment  
19 1 58

124  
The Dean & Chapter of Exeter  
E. Whitaker Lessee  
1<sup>st</sup> Allotment for Hanks Copy  
24 3 35

126  
5 3 33  
John Kenn  
9 3 7

125  
3 0 26

290  
Catherine Upjohn  
9 1 0

291  
Jos Barratt Esq  
7 3 18

286  
JOHN ROBERTS.  
3<sup>rd</sup> Allotment  
51 2 17

117  
E Whitaker Esq  
5<sup>th</sup> Allotment  
27 1 30

109  
E. Whitaker Esq  
17 3 26

292  
3 1 31

293  
8 1 0

289  
Jos. Andrews  
19 2 28

294  
Lord Shrewsbury  
1<sup>st</sup> Allotment  
19 3 14

110  
G. Shingleton.  
6 0 29

107<sup>a</sup>  
E. Whitaker Esq  
8 2 27

107  
5 0 30  
2 2 58

108  
8 3 14

295  
Jos<sup>r</sup> ANDREWS  
2<sup>nd</sup> Allotment  
30 0 3

THE BOWLING GREEN ROAD

104

102

103

404  
3 1 31

402  
4 2 4

401  
4 3 10

400

405  
4 1 16

406  
3 2 17

407  
5 3 4

396  
6 1 27

297  
3 0 22

298  
4 3 20

301  
W. J. Walker  
7 0 29

303  
Bernard Green  
12 0 31

304

307  
4 2 29

309  
5 3 55

310  
5 1 13

311  
5 1 25

383

381  
1 3 10

380  
3 0 32

379  
3 7 9

377  
3 7 7

375  
2 0 19

374

373

371  
4 1 38

370  
3 6 9

368

365

367

366

364  
John Roberts  
5<sup>th</sup> Allotment  
15 2 10

363

362

361

360

359

287  
SWINBROOK CHARITY  
29 2 7

288  
T. R. Wright  
5 2 7

Aston Public Road

Private Foot Way

THE BEBE

The Island More Private Road

D  
A  
W  
R

T  
H  
E  
B  
E

THE ASTON ROAD

Trulands Private Road

Public Footway to Aston





BLACKBOURTON ROAD  
JESUS COLLEGE  
2<sup>nd</sup> Allotment  
82. 1. 26.

546.

556

555

554

550

548

549

551

552

638

639

640

641

642

643

644

645

646

647

648

CLANVILLE

636

635  
10 5 10

TURNPIKE

651  
LORD SHREWSBURY  
3<sup>rd</sup> Allotment  
72 5 16

WELCOME WAY ROAD

595  
LORD SHREWSBURY  
5<sup>th</sup> Allotment  
29 3 32

629  
MADAMS PRIVATE R<sup>d</sup>  
7 2 36

654  
7 0 39  
Moore Lane Private Road

617  
617  
DRONE WAY PRIVATE ROAD  
684

589  
12 2 36

591  
7 2 14

590  
6 1 28

596  
595

605  
606

610  
611

612  
615

614  
616

607  
608

609  
609

686  
687

688  
689

692  
691

693  
694

695  
695

696  
697

698  
699

700  
701

702

582

583

584

585

586

587

588

589

590

591

592

593

594

595

T  
A  
N  
N  
I  
L  
L



P L A N N o V.

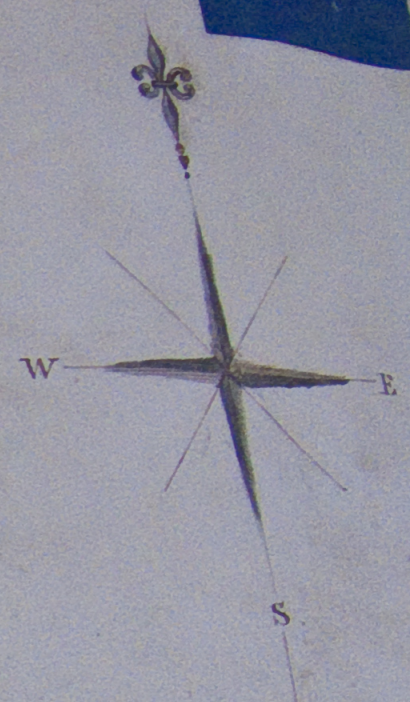

A W A R D P L A N

ROAD.  
LEDMER WAY ROAD

Lord Shrewsbury.  
5th Allotment.  
29 3 32.

Williams Private R<sup>d</sup>  
7 2 36

844.  
E. Whitaker Esq.  
1st Allotment.  
35 1 18.

845.  
Miss C. A. Horde.  
5th Allotment.  
49 5 10.

859  
Abingdon Poor.  
2nd Allotment.  
26 1 57.

847  
The Honble J. Coventry.  
1st Allotment.  
1st Allotment.

Public Foot Way to Rushey.



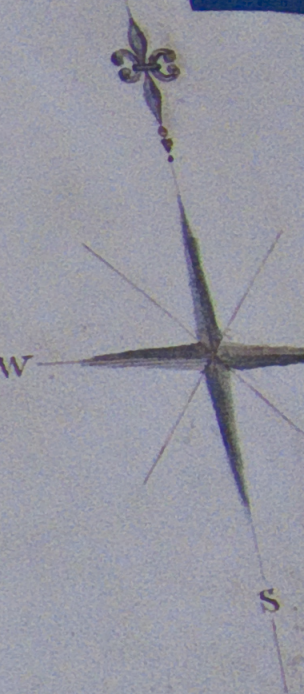

P L A N N<sup>o</sup> V.

A W A R D P



ROAD

WELCOME WAY ROAD

Kirk's Lane  
Pr. Road

589.  
12. 2. 36

844.  
E. Whitaker Esq.  
1<sup>st</sup> Allotment.  
55. 1. 18.

845.  
Miss C. A. Horde.  
5<sup>th</sup> Allotment.  
49. 3. 10.

595.  
Lord Shrewsbury.  
5<sup>th</sup> Allotment.  
29. 3. 32.

859  
Abingdon Poor  
2<sup>nd</sup> Allotment.  
26. 1.

847  
The Honble. J. C.  
H. Willmott

Public Foot Way to

592.  
7. 2. 14

590.  
6. 1. 28

596.  
595.  
598.

602.

605.

606.

604.

603.

858.

857.

856.

855.

585.

584.

599.

601.

602.

858.

857.

856.

855.

588.

581.

582.

869.

870.

846.

866.

865.

864.

863.

862.

861.

860.

859.

858.

857.

856.

855.

911.

843.

844.

845.

835.

832.

831.





PLAN NORTH

Shrewsbury  
29 5 32  
Molment

Williams Private R<sup>d</sup>  
7 2 36

629 36  
628  
625  
624  
627  
626  
622  
621  
6 5 20  
619  
618  
617  
616  
615  
614  
613  
612  
611  
610

Drone Way Private Road  
617  
616  
615  
614  
613  
612  
611  
610  
609  
608  
607  
606  
605  
604  
603  
602  
601

Public Foot Way to Clannville  
685  
684  
683  
682  
681  
680  
679  
678  
677  
676  
675  
674  
673  
672  
671  
670  
669  
668  
667  
666  
665  
664  
663  
662  
661  
660  
659  
658  
657  
656  
655  
654

Upwell Field Private Road  
685  
684  
683  
682  
681  
680  
679  
678  
677  
676  
675  
674  
673  
672  
671  
670  
669  
668  
667  
666  
665  
664  
663  
662  
661  
660  
659  
658  
657  
656  
655  
654

Public Foot Way to Rushey  
859  
858  
857  
856  
855  
854  
853  
852  
851  
850  
849  
848  
847  
846  
845  
844  
843  
842  
841  
840  
839  
838  
837  
836  
835  
834  
833  
832  
831  
830  
829  
828  
827  
826  
825  
824  
823  
822  
821  
820  
819  
818  
817  
816  
815  
814  
813  
812  
811  
810  
809  
808  
807  
806  
805  
804  
803  
802  
801  
800  
799  
798  
797  
796  
795  
794  
793  
792  
791  
790  
789  
788  
787  
786  
785  
784  
783  
782  
781  
780  
779  
778  
777  
776  
775  
774  
773  
772  
771  
770  
769  
768  
767  
766  
765  
764  
763  
762  
761  
760  
759  
758  
757  
756  
755  
754  
753  
752  
751  
750  
749  
748  
747  
746  
745  
744  
743  
742  
741  
740  
739  
738  
737  
736  
735  
734  
733  
732  
731  
730  
729  
728  
727  
726  
725  
724  
723  
722  
721  
720  
719  
718  
717  
716  
715  
714  
713  
712  
711  
710  
709  
708  
707  
706  
705  
704  
703  
702  
701  
700  
699  
698  
697  
696  
695  
694  
693  
692  
691  
690  
689  
688  
687  
686  
685  
684  
683  
682  
681  
680  
679  
678  
677  
676  
675  
674  
673  
672  
671  
670  
669  
668  
667  
666  
665  
664  
663  
662  
661  
660  
659  
658  
657  
656  
655  
654

James Dewe  
19 0 7  
705  
704  
703  
702  
701  
700  
699  
698  
697  
696  
695  
694  
693  
692  
691  
690  
689  
688  
687  
686  
685  
684  
683  
682  
681  
680  
679  
678  
677  
676  
675  
674  
673  
672  
671  
670  
669  
668  
667  
666  
665  
664  
663  
662  
661  
660  
659  
658  
657  
656  
655  
654

The Rev. G. Richards  
3rd Molment for Tithes  
65 1 18  
685  
684  
683  
682  
681  
680  
679  
678  
677  
676  
675  
674  
673  
672  
671  
670  
669  
668  
667  
666  
665  
664  
663  
662  
661  
660  
659  
658  
657  
656  
655  
654

The Rev. G. Richards  
2nd Molment for Tithes  
82 2 26  
680  
679  
678  
677  
676  
675  
674  
673  
672  
671  
670  
669  
668  
667  
666  
665  
664  
663  
662  
661  
660  
659  
658  
657  
656  
655  
654

The Rev. G. Richards  
1st Molment  
53 5 15  
847  
846  
845  
844  
843  
842  
841  
840  
839  
838  
837  
836  
835  
834  
833  
832  
831  
830  
829  
828  
827  
826  
825  
824  
823  
822  
821  
820  
819  
818  
817  
816  
815  
814  
813  
812  
811  
810  
809  
808  
807  
806  
805  
804  
803  
802  
801  
800  
799  
798  
797  
796  
795  
794  
793  
792  
791  
790  
789  
788  
787  
786  
785  
784  
783  
782  
781  
780  
779  
778  
777  
776  
775  
774  
773  
772  
771  
770  
769  
768  
767  
766  
765  
764  
763  
762  
761  
760  
759  
758  
757  
756  
755  
754  
753  
752  
751  
750  
749  
748  
747  
746  
745  
744  
743  
742  
741  
740  
739  
738  
737  
736  
735  
734  
733  
732  
731  
730  
729  
728  
727  
726  
725  
724  
723  
722  
721  
720  
719  
718  
717  
716  
715  
714  
713  
712  
711  
710  
709  
708  
707  
706  
705  
704  
703  
702  
701  
700  
699  
698  
697  
696  
695  
694  
693  
692  
691  
690  
689  
688  
687  
686  
685  
684  
683  
682  
681  
680  
679  
678  
677  
676  
675  
674  
673  
672  
671  
670  
669  
668  
667  
666  
665  
664  
663  
662  
661  
660  
659  
658  
657  
656  
655  
654





631.  
LORD SHREWSBURY  
3rd Allotment.  
72. 3. 16

629. 2. 36  
Malliams Private R<sup>d</sup>

859  
Abingdon Poor.  
2nd Allotment.  
26. 1. 57

847  
The Honble. J. Coventry.  
H. Williams Lessee  
1st Allotment.  
55. 5. 15

685.  
The Rev. G. Richards.  
3rd Allotment for Tithes  
65. 1. 18.

696  
I. & T. Dewe.  
1st Allotment.  
53. 2. 10.

705.  
James Dewe.  
19. 0. 7.

680.  
The Rev. G. Richards.  
2nd Allotment for Tithes  
82. 2. 26

The Rev. G. Richards.

645  
646  
647  
648. 9. 0. 2  
649.  
650.  
651.  
652.  
653.  
654.  
655.  
656.  
657.  
658.  
661.  
662.  
665.  
666.  
668.  
670.  
673.

619.  
618.  
617.  
616.  
615.  
614.  
613.  
612.  
611.  
610.  
609.  
608.  
607.  
606.  
605.

686.  
687.  
688.  
689.  
690.  
691.  
692.  
693.  
694.  
695.

850  
12. 3. 4.

849.  
850.  
851.  
852.  
853.

847<sup>a</sup>  
11. 5. 0.

701.  
702.  
703.  
704.  
705.  
706.  
707.  
708.

709.  
20. 5. 0

710.  
8. 0. 19.

P  
A  
R